

DK. Reservedele
 UK. Spare Parts
 DE. Ersatzteile

ASTM F 963
 ANSI Z315.1
 16 CRF 1303

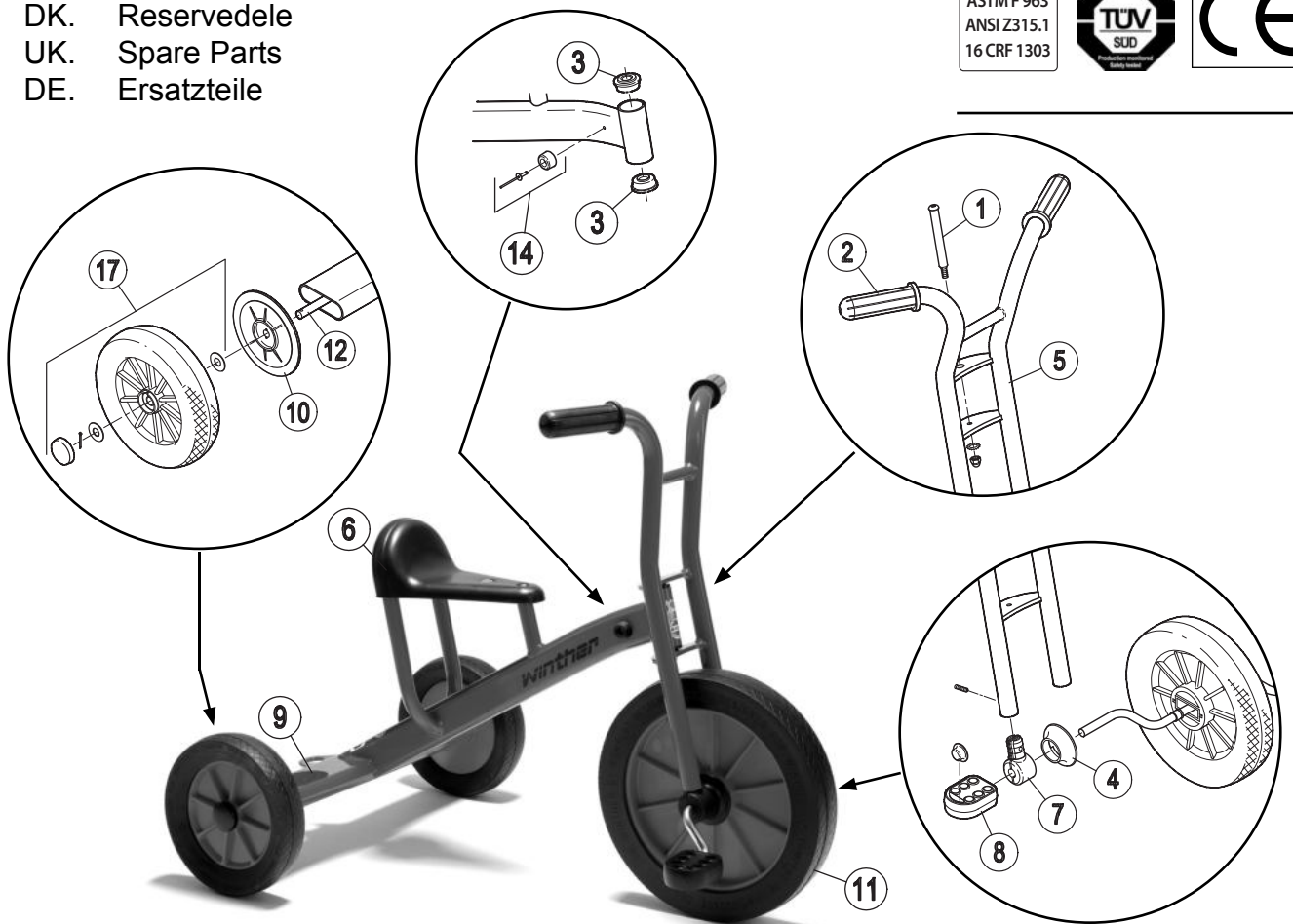

Pos.		Pos.		Pos.	
1	x1 x2 x1	7	x2 x2 x1	13	x4 x2 x2
2	x2 x2	8	x2 x2	14	x2 x2
3	x2	9	x2	15	
4	x2	10	x2	16	
5		11		17	
6		12		18	

DK. Reservedele
 UK. Spare Parts
 DE. Ersatzteile

ASTM F 963
 ANSI Z315.1
 16 CRF 1303

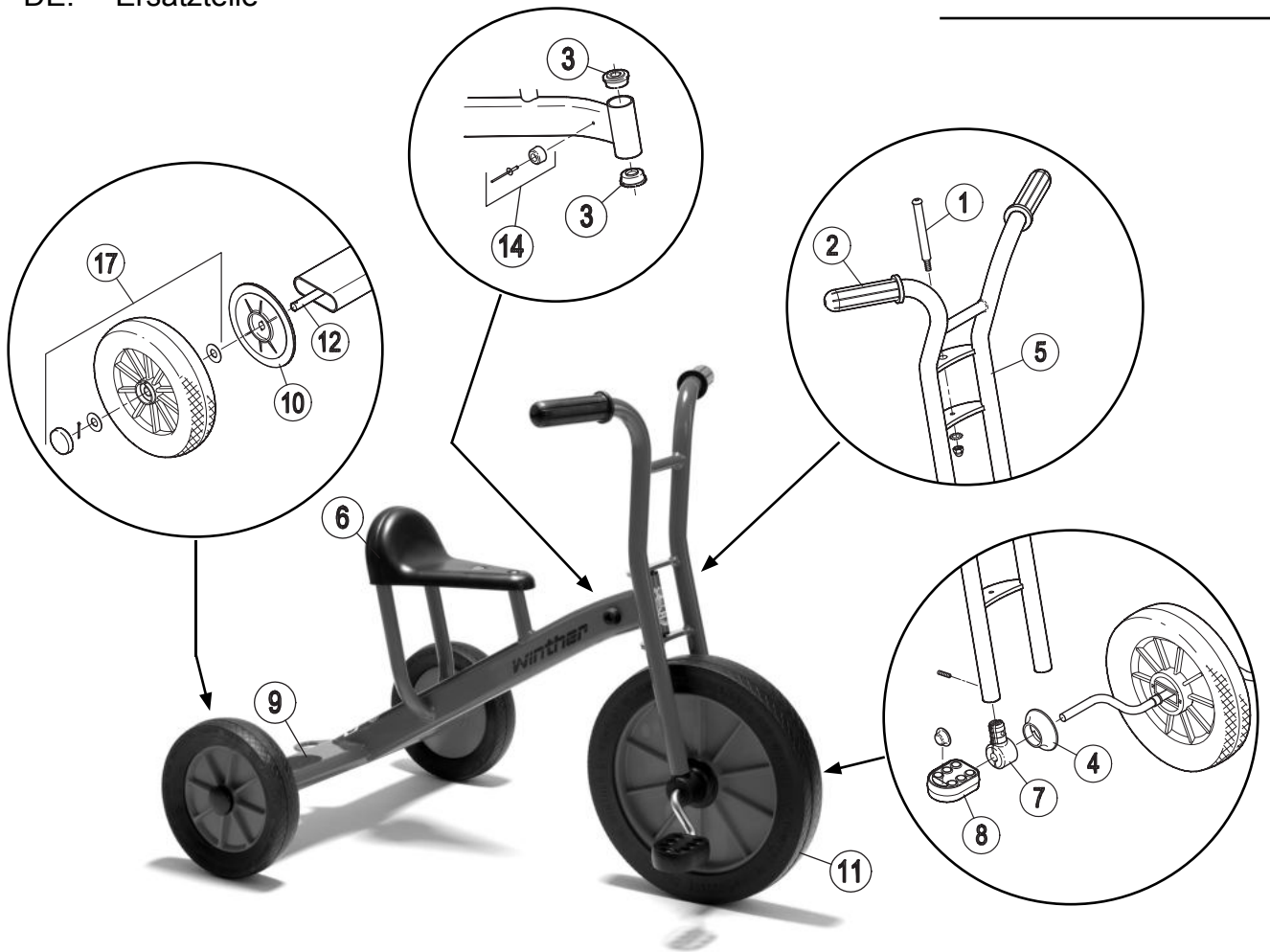

45200									
Version									
Pos.	2.0								
1	50501								
2	50503								
3	50504								
4	50505								
5	50552								
6	50580								
7	50506								
8	50510								
9	50511								
10	50519								
11	50562								
12	50514								
13	50520								
14	50531								
15	-								
16	-								
17	50571								
18	-								